

**PLAT OF SURVEY PREPARED FOR:
BRUCE W. AND BRENDA H. GOODMAN**
DEED OF RECRD: VOLUME 1054, PAGE 1128

MUNSON TOWNSHIP	MAY	ONE
	1997	ONE
SURVEY FOR BRUCE AND BRENDA GOODMAN		DRAWN BY: RLK/CAD



GRAPHIC SCALE: 1" = 100'

HEATH ROAD 60'
N 5°28'36" E

VALLEY VIEW ACRES SUBDIVISION PLAT VOLUME 4, PAGE 33 AND 34

1" IRON PIN IN MONUMENT BOX FD. AND USED

1282.05' TOTAL meas.
545.34' calc.

150.03' calc.
150.03' calc.

1" IRON PIPE FD. @ 32.38' AND USED
5/8" IRON PIN SET

B.J. SCHIFFAUER 914-1110

S/L NO. 17

N 85°51'20" W

1537.50' C.L. - 1507.49'R/W (1505.12' 1" IRON PIPE FD.)calc.

5.297 ACRE PARCEL
DEED OF RECORD: VOLUME 1054, PAGE 1128

3/4" IRON PIPE FD. AND USED

S/L NO. 18

ORIGINAL LOT NO. 1

N 85°51'20" W

1539.48' C.L. - 1509.47'R/W (1507.35' 1" IRON PIPE FD.)calc.

1" IRON PIPE FD. @ 32.13' AND USED
5/8" IRON PIN SET

C.J. ANTHONY 684-857

ORIGINAL LOT NO. 20

S/L NO. 19

1" IRON PIPE FD. AND USED

150.00' rec.
N 4°43'10" E

GEAUGA COUNTY PARK DISTRICT 870-893

SITUATED IN THE TOWNSHIP OF MUNSON,
COUNTY OF GEAUGA AND STATE OF OHIO
AND KNOWN AS BEING SUBDIVISION LOT NO. 18
IN VALLEY VIEW ACRES SUBDIVISION OF PART
OF ORIGINAL LOT NO. 1 AND 20, TRACT NO. 3, WITHIN
SAID TOWNSHIP AS SHOWN IN PLAT VOLUME 4, PAGE 33 OF
GEAUGA COUNTY RECORDS AND DEEDS.

MONUMENTS WERE FOUND OR SET AS INDICATED HEREON.
DISTANCES ARE IN FEET WITH DECIMAL PARTS.
BEARINGS ARE TO AN ASSUMED MERIDIAN AND INDICATE ANGLES ONLY.
I HEREBY CERTIFY THAT I HAVE SURVEYED THESE PREMISES AND PREPARED
THIS PLAT OF SURVEY IN ACCORDANCE WITH THE PROVISIONS
OF CHAPTER 4733-37 OF THE OHIO REVISED CODE.

Delmar B. Kosie
DELMAR B. KOSIE
REGISTERED SURVEYOR NO. 5276

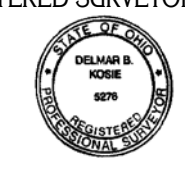

1" IRON PIN IN MONUMENT BOX FD. AND USED

PLAT OF SURVEY PREPARED BY:
DELMAR B. KOSIE AND ASSOCIATES
200 SOUTH STREET
CHARDON, OHIO 44024
PHONE: 216-286-2131