

<p>Situated in The</p> <p>Township of Mesopotamia, County of Trumbull and State of Ohio and known as being part of Original Lot 7 within said Township and Township 7N, Range 5W in the Connecticut Western Reserve</p>	<p>Month:</p> <p>June</p>	<p>Page:</p> <p>ONE</p>
	<p>Year:</p> <p>2021</p>	<p>of</p> <p>ONE</p>
<p>Survey for: Joanne M. Prochazka, Trustee</p>		

BASIS OF RESEARCH AND RECORDS

All county ownership research data and previous survey records were obtained from The County Recorder's Office and Map Room. All county centerline and right-of-way data was obtained from The County Engineer's Office. All state centerline and right-of-way data was obtained from The Ohio Department of Transportation Records.

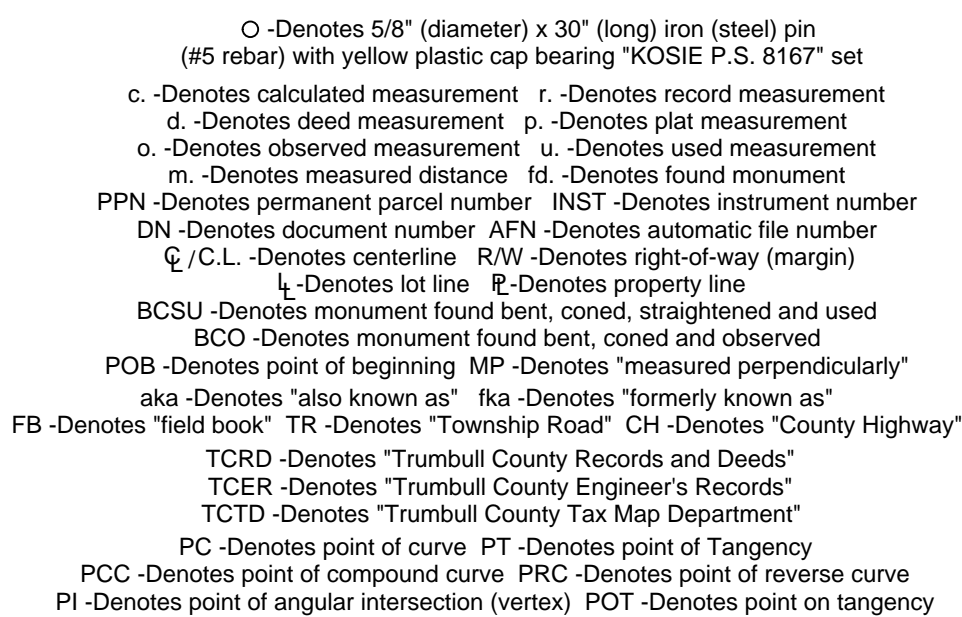

PPN 60-037100
Michael Mitrega, Stephen Mitrega,
Susan Love and Lisa Hanley
INST 201102110002701

REFERENCES

*The May 10th, 1878 survey and Original Road Records for Mahan Parker Road, recorded in Volume 5, Pages 310 to 324 of TCRD.
 *The October 2004 surveys prepared by Jerry W. Daniel, Registered Surveyor 6222, recorded in INST 201710040027649 and INST 200411180037343 of TCRD.
 *The May, 2003 surveys prepared by Foresight Engineering Group, Inc, Steven N. Roessner P.S. 7070, recorded in INST 200312230064651 and 200312230054652 of TCRD.



SURVEYOR'S CERTIFICATION

I certify to: Joanne M. Prochazka, Trustee

that I have surveyed these premises and prepared this Plat of Survey in accordance with the provisions of Chapter 4733-37 of the Ohio Revised Code governing Land Surveys in the State of Ohio. The bearings shown hereon are based on True North, and the distances are in feet and decimal fractions thereof (NAD83 2011), NAVD83, GRSS80, GEDOID18. Distances are based on U.S. feet with decimal parts. The above certification is intended only to those parties named herein, and is valid only when accompanied by an original signature block thereon. In accordance with the provisions of Chapter 4733-37 of the Ohio Revised Code, the State's Limitations of the Survey hereby expires four (4) years from the date shown hereon. The undersigned has not been provided a Title Examination and this Survey is based only on the information furnished to the undersigned by the parties to the Survey, and no other documents that may affect the surveyed premises that would be revealed by a Title Examination. The undersigned assumes no liability for the use of, or unauthorized copies of this Plat of Survey, nor for any use, or reliance upon, by persons other than those specifically named herein for the intended purpose of this survey.

Robert L. Kosie, P.S.
Registered Professional
Land Surveyor No. 816

Signed and sealed on this 24th day of June, 2021



No effort was made in determining the centerline of Countyline Donley Road northwest of this point

1/2" iron pipe
fd. and used
PI

5/8" iron pin
with cap bearing
"FORESIGHT ENGINEERING"
fd. @ 30.07' from C.L.
(not on R/W)
and used for
property line (n/s)

3/4" iron pin fd.
south 2.73',
west 65.50'
not used in survey
5/8" iron pin
set R/W

COUNTYLINE DONLEY ROAD
(CH 302, Section E, 60 feet wide)

MESOPOTAMIA TOWNSHIP

BLOOMFIELD TOWNSHIP
MAHAN PARKER ROAD
(TR 305, Section C, 36 feet wide)
66°16'41" W 66°16'34" pin set to pin rd, total road length c.

MAHAN PARKER ROAD
(TR 305, Section B, 40 feet wide)

1* iron pipe fd.
south 0.13', west 7.25'
(S89°00'46"W, 7.25' c.)
and used for
centerline (e/w)
5/8" iron pin set

No effort was made in determining the centerline of Mahan Parker Road, Section D, in this survey.

MAHAN PARKER
ROAD
TR 305, Section D, 40 feet wide

89°-47'-00" d./c.&u.

3/4" iron pipe fd.
@ 18.09' from C.L.
(MP, not on R/W) ———
and used for
property line (e/w)
N 89°00'46" E
18.00'

1

1" iron pipe
fd. and used

1" iron pipe fd.
 @ 18.10' from C.L.
 (MP, not on R/W)

1" iron pipe
fd. and used

1" iron pipe fd.
 @ 18.15' from C.L.
 (MP, not on R/W)

1" iron pipe fd.
@ 18.24' from C.L.
(MP, not on R/W)

3620.7 | 1" iron pipe fd.
| @ 18.13' from C.L.
| 90° (MP, not on R/W)

1" iron pipe fd.
@ 18.43' from C.L.
(MP, not on R/W)

1" iron pipe fd.
@ 18.28' from C.L.
(MP, not on R/W)

— c. & u.

90° ● *GARY R TANERI
@ 18.25' from C.
(MP, not on R/W)

MATCH LINE 'A'

COUNTYLINE
DONLEY
ROAD
(302, Section A, 40 feet wide)

No effort was made in determining any centerline information south or east of this intersection in this survey.